

LEASING

REINLI BUSINESS PARK



CONVENIENTLY LOCATED JUST SOUTH OF HWY. 290 ONE BLOCK EAST OF IH-35

- Office/Warehouse space
- Two offices (11' x 12') with overhead door (10' x 10') at grade
- 12' clear height
- Tenant signage over space and on pylon on Reinli

Joseph Hoover Company

Real Estate Investments

PH: 512.457.9925

hoover@josephhoover.com

THE INFORMATION CONTAINED HEREIN WAS OBTAINED FROM SOURCES BELIEVED RELIABLE; HOWEVER, JOSEPH HOOVER COMPANY MAKE NO GUARANTEES, WARRANTIES OR REPRESENTATION AS TO THE COMPLETENESS OR ACCURACY THEREOF. THE PRESENTATION OF THIS PROPERTY IS SUBMITTED SUBJECT TO ERRORS, OMISSIONS, CHANGE OF PRICE, PRIOR SALE OR LEASE OR WITHDRAWAL WITHOUT NOTICE

UNIT 8
SPACE PLAN
Approximately 1,820 Square Feet

Not to Scale

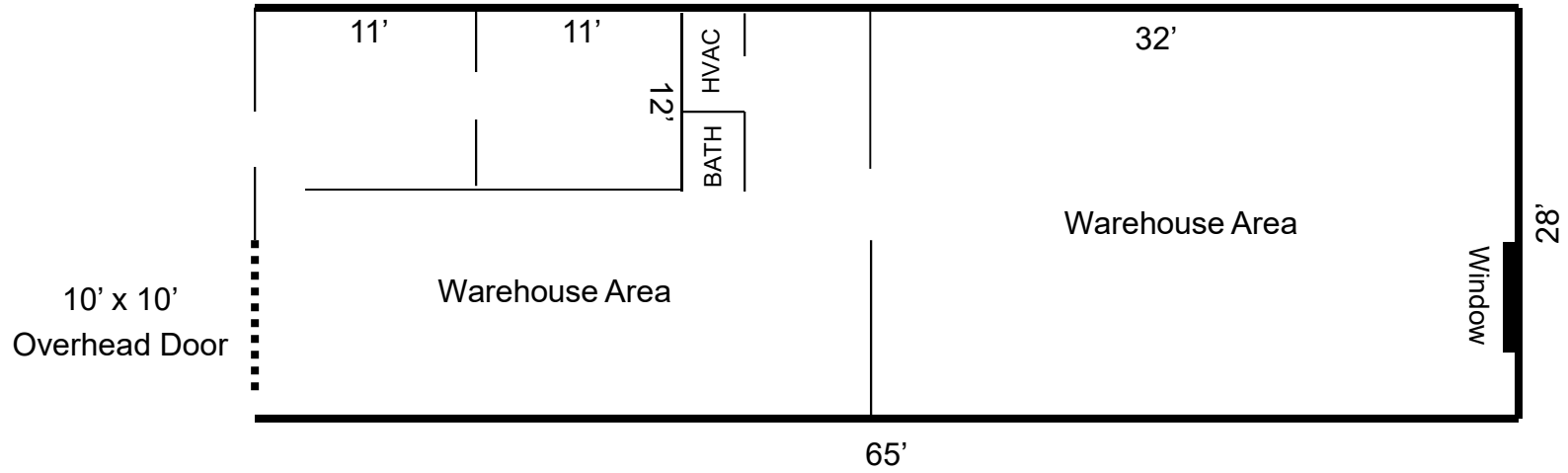

REINLI BUSINESS PARK

1029 Reinli Street

Austin, Texas